



乐清市裕林电子有限公司

Yueqing Yulin Electronic Co., Ltd

Address: No.721 Huancheng East Road ,Tantou Village ,Liushi,YueQing,Zhejiang China 325604

Tel: 0577-27878383

Website: www.pilotlamp.cn

Fax: 0577-27878383-8027

## SPECIFICATION FOR APPROVAL

### 规格说明书

CUSTOMER'S CODE

本厂代码:

DESCRIPTION

Rocker Switch

品 名:

SPECIFICATION

规 格:

30×22

DATE

编制日期:

2018-11-29

PART NO.

本厂型号:

FL3-KCD4-201N-5K\_SS

REFERENCE No.

档案编号:

FL3-KCD4-0124-21-□□□□□-112-0000-00-YXBXW-00-01

Approved By Customer

编 制

Qualified By

审 核

Form Designer

批 准



乐清市裕林电子有限公司

Yueqing Yulin Electronic Co., Ltd

Address: No.721 Huancheng East Road ,Tantou Village ,Liushi,YueQing,Zhejiang China 325604

Tel: 0577-27878383

Website: [www.pilotlamp.cn](http://www.pilotlamp.cn)

Fax: 0577-27878383-8027

## 1. Picture:



## 2.drawing

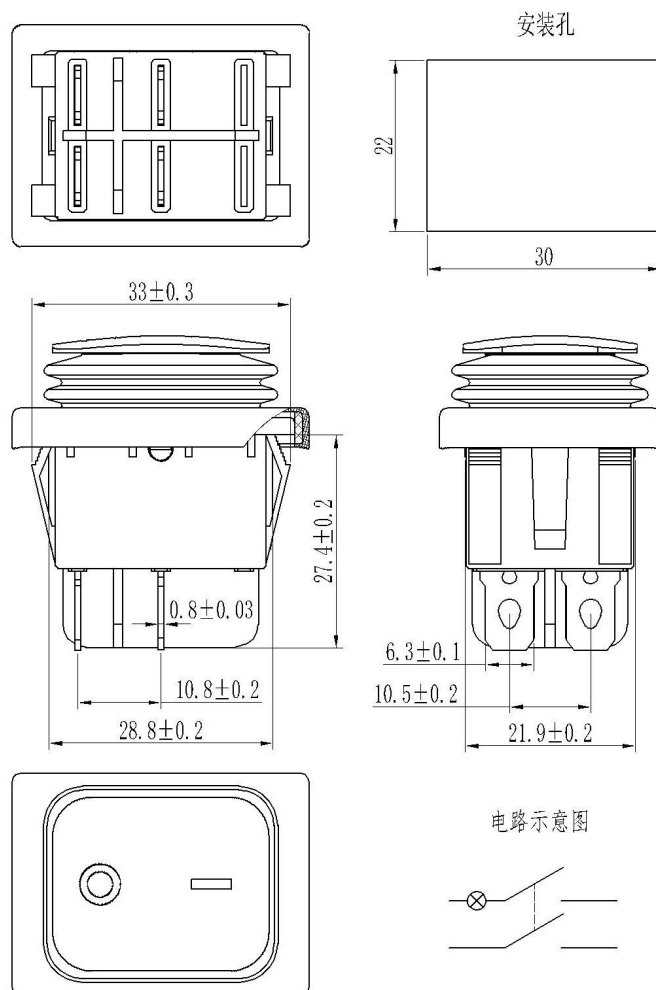



乐清市裕林电子有限公司

Yueqing Yulin Electronic Co., Ltd

Address: No.721 Huancheng East Road ,Tantou Village ,Liushi,YueQing,Zhejiang China 325604

Tel: 0577-27878383

Website: [www.pilotlamp.cn](http://www.pilotlamp.cn)

Fax: 0577-27878383-8027

### 3Material:

Accessories name	Material
plate	stainless steel
button	PC
Waterproof cover	Rubber
Waterproof frame	PVC
holder	PC
lamp-socket	PA66
spring	72#
Iron case	08F
Rocker	Brass H62
Terminals	Brass H62
contact	AgCd012
base	PA66
Light comp	

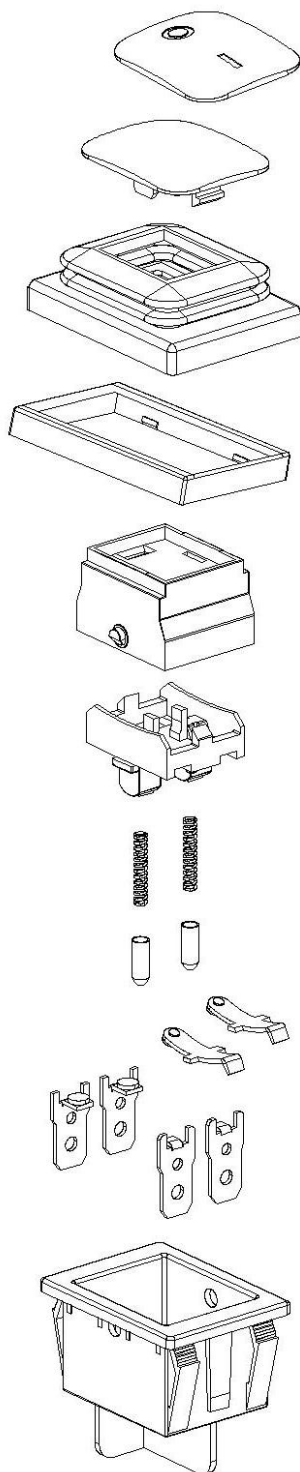



乐清市裕林电子有限公司

Yueqing Yulin Electronic Co., Ltd

Address: No.721 Huancheng East Road ,Tantou Village ,Liushi,YueQing,Zhejiang China 325604

Tel: 0577-27878383

Website: www.pilotlamp.cn

Fax: 0577-27878383-8027

#### 4 Temperature Range:

Working environment temperature:  $-25^{\circ}\text{C} \sim +85^{\circ}\text{C}$ 。

#### 5 Out looking and operation feeling:

##### 5.1 Clear and firm marking;

The appearance is clean and beautiful, no deformation, no damage, no cracking;

No rust, no electroplating;

The components are firmly connected, no looseness, no falling off;

##### 5.2 The switch operation is flexible, no jamming, no obvious friction.

#### 6 Electrical Capacity:

Item		test condition	technical requirements
6.1	Rating	15A 250VAC	
6.2	Contact Resistance	Test <1KHz	$\leq 200\text{m}\Omega$
6.3	Insulation resistance	Working at DC500V Between pins and housing, in 1 mins	$\geq 100\text{M}\Omega$
6.4	Withstand Voltage	Working at AC1500V Between pins , in 10 seconds; Working at AC3000V Between pins and housing, in 10 seconds	No breakdown or flashover
6.5	Electrical Endurance	Under rated load, 30 operations per minute for a total of 10,000 operations.	1. Appearance and feel are acceptable; 2. Contact resistance $\leq 2\Omega$ ; 3. Terminal temperature rise $\leq 55\text{K}$ ; 1. The pressure test is qualified.



乐清市裕林电子有限公司

Yueqing Yulin Electronic Co., Ltd

Address: No.721 Huancheng East Road ,Tantou Village ,Liushi,YueQing,Zhejiang China 325604

Tel: 0577-27878383

Website: www.pilotlamp.cn

Fax: 0577-27878383-8027

## 7 Mechanical Capacity:

7.1	Operation force	The switch is placed perpendicular to the direction of operation, applying a force on one side of the button to measure the maximum force required to turn the switch on.	As customer required.
7.2	Terminal Strength	Apply a 60N static load, always pushed inward, to the top of the terminal for 60 seconds.	The terminal is free from damage and falling off, and the switch function is normal.

Item	test condition		technical requirements
7.3	Solder ability	The terminal into the molten tin bath, temperature of $235 \pm 5$ °C, time of $3 \pm 0.5$ seconds.	More than 90% of the immersed portion is covered with tin.
7.4	Resistance to soldering Heat	Terminal welding part of the immersion temperature for $260 \pm 5$ °C molten tin furnace $3 \pm$ Manual soldering iron welding, the welding temperature of $350 \pm 5$ °C, welding time $3 \pm 1$ seconds. No pressure shall be applied to the terminals during welding.	The body has no obvious deformation; Mechanical performance, electrical performance test qualified.

## 8 Weathering Performance:

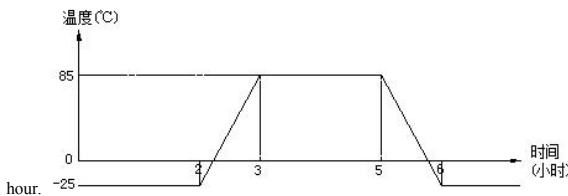
8.1	high temperature resistance	In $85 \pm 2$ °C for 72 hours, and then placed in a natural environment test in 1 hour.	Out looking and operation felling pass; Contact resistance $\leq 2$ $\Omega$ ; high-voltage insulation test ok; Mechanical qualification ok
8.2	hot-wet	In $40 \pm 2$ °C, humidity 91% 95% RH conditions for 96 hours, and then placed in a natural environment test in 1 hour	
8.3	low temperature resistant	Under the environment of $25 \pm 2$ °C for 12 hours, and then placed in a natural environment test in 1 hour.	
8.4	alternative temperature	<p>According to the temperature and time shown in the figure, the temperature alternation was carried out for 5 consecutive cycles, and then the test was carried out in the natural environment for 1</p>  <p>温度(°C)</p> <p>85</p> <p>0</p> <p>-25</p> <p>时间(小时)</p> <p>hour.</p>	